



MAT CLEANER OPERATION MANUAL

Need Support?
email: helpme@matwizard.com
(251) 281-0411



TABLE OF CONTENTS

Page 1

Introduction

- Specifications
- Installation
- Connection

Page 2

- Using the Mat Wizard
- Caution

Page 3

- Troubleshooting
 - Not running
 - Breaker tripping
 - Mat not feeding through
 - No water coming through
 - Does not clean the mat well
 - Mat stuck inside the mat machine
- How to adjust settings

Page 4

- Dimensions

Pages 5-11

- Parts list and diagrams

Page 12

- * Electrical control box diagram

Page 13

- Electric drawing



Thank you for purchasing a Mat Wizard!

The Mat Wizard is made of industrial grade stainless steel to provide maximum corrosion resistance. Designed to clean most cloth and rubber mats using a high-speed bristle brush and high velocity air blowers with or without a clean water rinse. It's a user friendly design with a single push of a button. Cleans mats up to 27.5" in less than 60 seconds. The built in anti-freezing device on the internal water plumbing makes this unit suitable for year-round use. For questions or concerns visit us at www.matwizard.com, email helpme@matwizard.com or call (251) 281-0411.

Specifications

- Dimensions: 42.5"Wx36.5"Lx41.5H
- Electric requirement (1/2 HP motors): 110V, single phase, 60 Hz
- Electric motors (blast motors): 110V/1050W, single phase, 60 Hz
- Weight: 452 lbs (205 kg)
- Steel material: 1.2 T - 2/5 T SUS

Prior to installation, a licensed plumber will need to install a freshwater outlet and a drain to sewer. A licensed electrician will need to install a dedicated 120-volt 30-amp circuit for the power. Your Mat Wizard will need to be placed on a flat level surface.

Installing your Mat Wizard

Step 1

Connect the fresh water supply.

Remove the supplied 5/8 inches water hose from the right side of the Mat Wizard.

Hook up one side of the hose using the fittings on the back of the Mat Wizard. Hook up the other side of the hose to fresh water. Adjust water valve, located in the bottom right inside panel.

Step 2

Connect the drain to sewer

Remove the supplied 1.5 inch drain hose from under the Mat Wizard.

Insert the hard plastic end into the drain port, located on the back of the Mat Wizard.

Insert the other end into a sewage drain.



Step 3

Have a licensed electrician connect electrical.

The lights on the display should be on at this point. If not, check that the breaker inside the Mat Wizard control box is on.

Step 4

Adjusting the R/T Belt.

Prior to operating your new Mat Wizard, The Rough Top Belt tension must be checked. At times during shipping, the tension bolts may loosen. The R/T Belt must only have 1/2 inch play, up or down, from the center.

To adjust, using a 6MM Hex Wrench, tighten one of the bolts until proper tension is achieved. Next, measure the distance from the inside edge of the mounting bracket to the wing nut. Using this measurement, adjust the opposite side.

Using your Mat Wizard

- Turn the toggle switch to “wet” or “dry”.
- Press the “RUN” button.
- Insert mat, upside down, into the mat feeder slowly.
- Press “STOP” when you are done.

Caution

- Do not insert mats larger than 27.5” wide.
- No minors or small children are allowed to operate the Mat Wizard.
- Do not insert your hands or fingers into the mat feeder.
- Do not insert folded mat. Mats must lay flat.
- Do not insert towels, cushions, damaged mats, mats containing metal or other bulky items, or plastic molded mats, such as weather mats.
- Clean the tray regularly to clear debris, sand, soil, and dirt.
- Check the tension of V-belts and replace if needed.
- Check the tension of R/T belt and adjust if needed.
- This Mat Wizard is designed to use 110/120 voltage, single-phase electricity ONLY

Troubleshooting

My Mat Wizard is not running.

- Check main power line & breaker.
- Check Thermal Overload.
- Contact an electrician.

The breaker is tripping.

- Check breaker, unplug it. Replace the plug if not working properly.
- Check ½ HP motor.
- Check blast motors.

The mat is not feeding through properly.

- Check all V-belts for loose/wear & tear. Adjust or replace if needed.
- Check R/T belt tension.

No water is coming through.

- Check solenoid valve.
- Check the water line for proper flow.

The Mat Wizard does not clean the mat well.

- Check the bristle brush for wear or obstruction, clean/replace as needed.
- Ensure water manifold is operating correctly.

The mat is stuck inside the Mat Wizard.

- Open top hood and loosen R/T belt tension.
- Pull the mat out slowly.
- Re-adjust tension on R/T belt.
- Check for foreign objects.

* If you have further questions or concerns, please contact us at helpme@matwizard.com.

How to adjust settings

Setting table (press setting button on main board)

The number of presses will display the instructions.

- 1 press - "1p" initial working amount
- 2 press - "1t" initial output operation time
- 3 press - "2p" additional amount used during operation
- 4 press - "2t" additional usage time during operation
- 5 press - "co" company code
- 6 press - "ad" equipment number
- 7 press - "tst" free mode (1), Paid mode (0)
- 8 press - "tt" coin sales, card sales
- 9 press - back to the first

Mat Wizard Dimensions

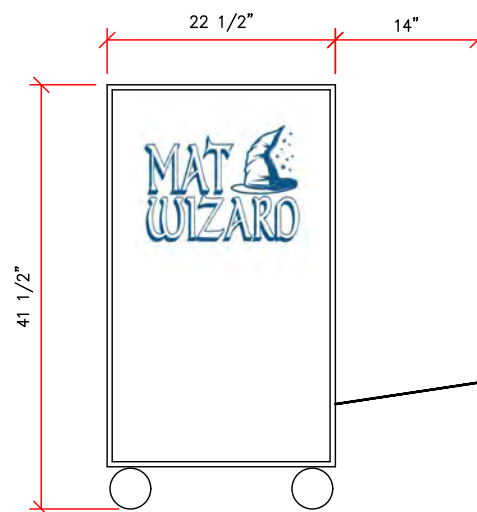
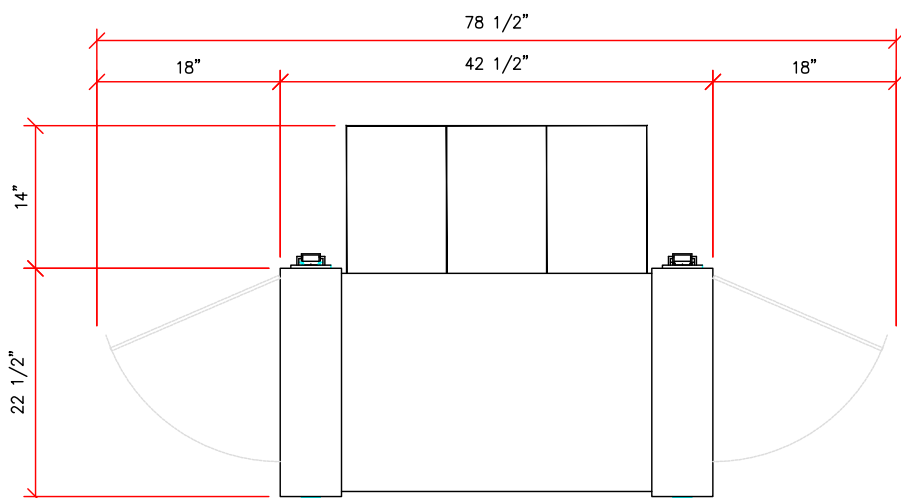

#	PART LIST AND DIAGRAM - ATTACHED
1	DRAWING #1 FOR ASSEMBLY
2	DRAWING #2 FOR 1/2 HP MOTORS AND BLAST MOTORS.
3	DRAWING #3 FOR WATER LINE AND THE RIGHT SIDE PANEL
4	DRAWING #4 THE LEFT SIDE OF PANEL
5	DRAWING #5 FOR ELECTRICAL CONTROL BOX
6	DRAWING #6 FOR ELECTRICAL CONTROL BOX DIAGRAM
7	DRAWING #7 ELECTRICAL DRAWING

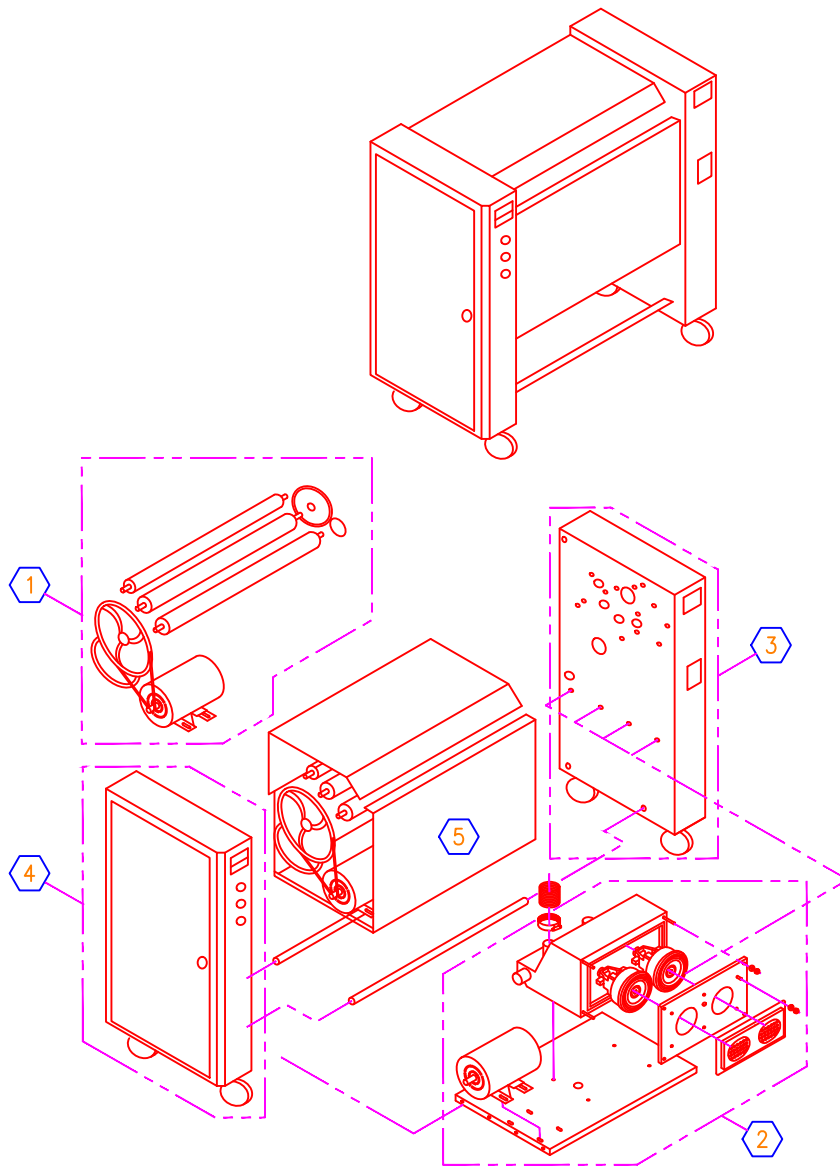



#	NAME
1	1/2 HP MOTOR
2	ON BUTTON
3	OFF BUTTON
4	DISPLAY PANEL
5	WET/DRY TRIGGER SWITCH

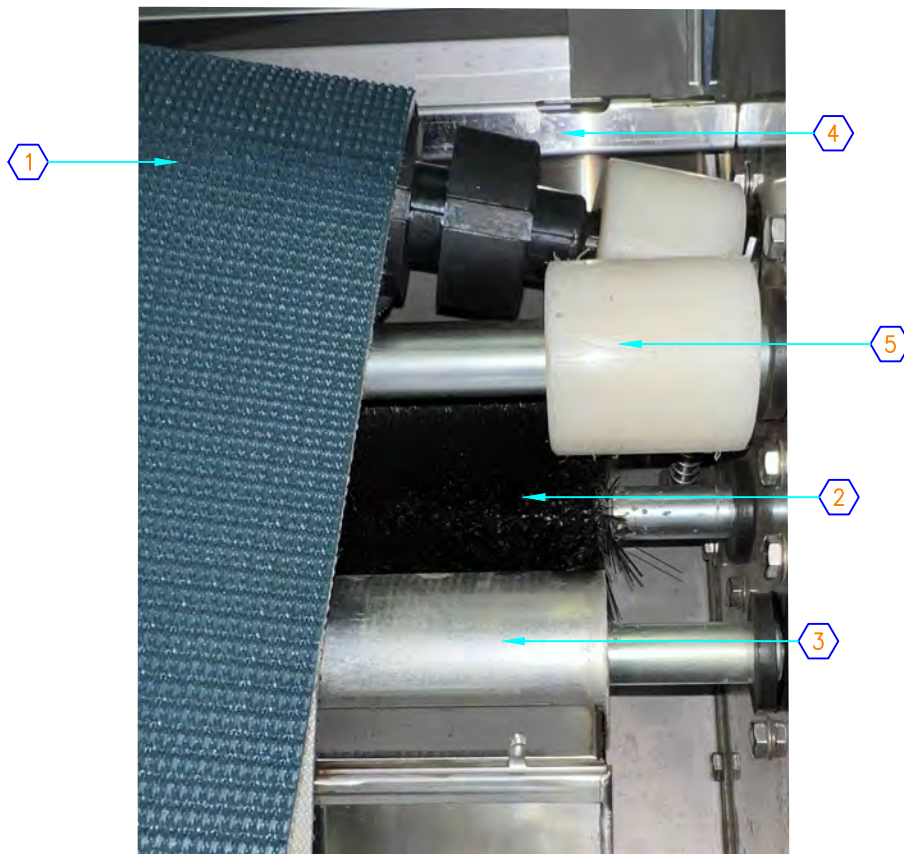

#	NAME
1	R/T BELT
2	BRISTLE BRUSH ROLLER
3	SPINNING ROLLER
4	MAT GUIDE PLATE
5	GUIDE PE ROLLER

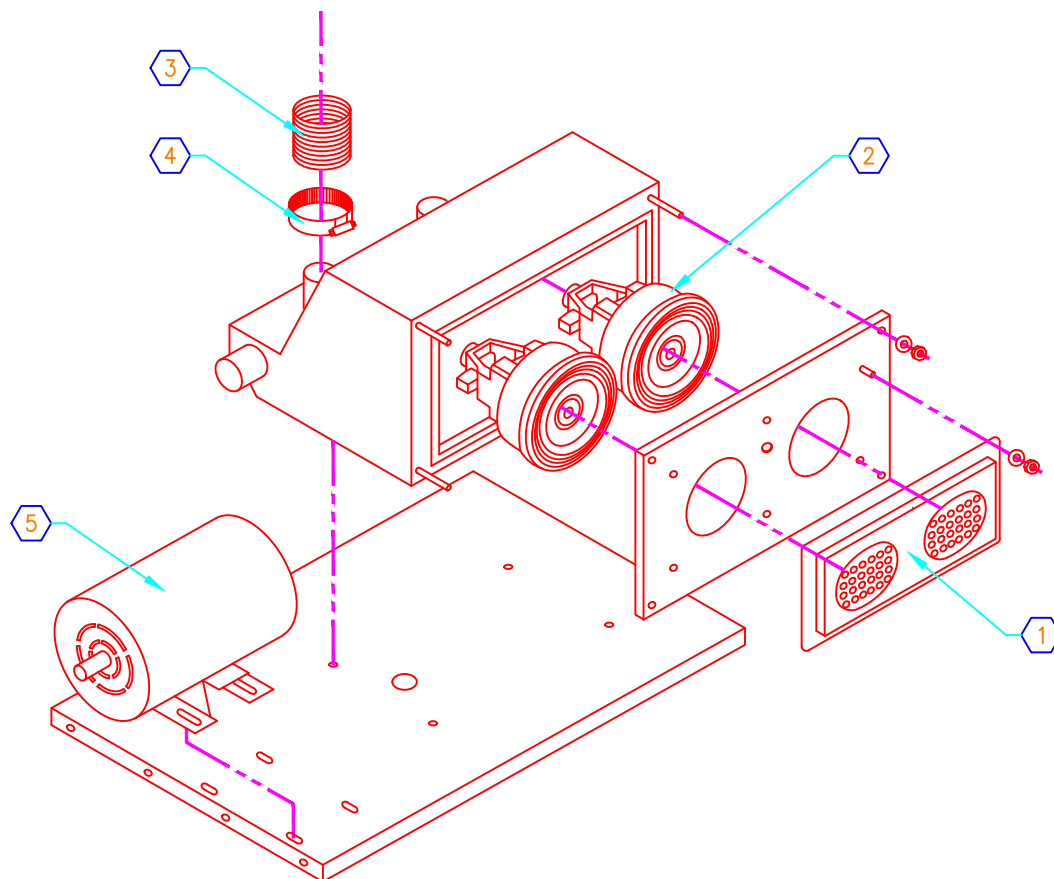

#	PART NAME
1	BLAST MOTOR FAN STRAINER
2	AIR BLAST MOTOR
3	AIR HOSE
4	HOSE CLAMP
5	½ HP MOTOR

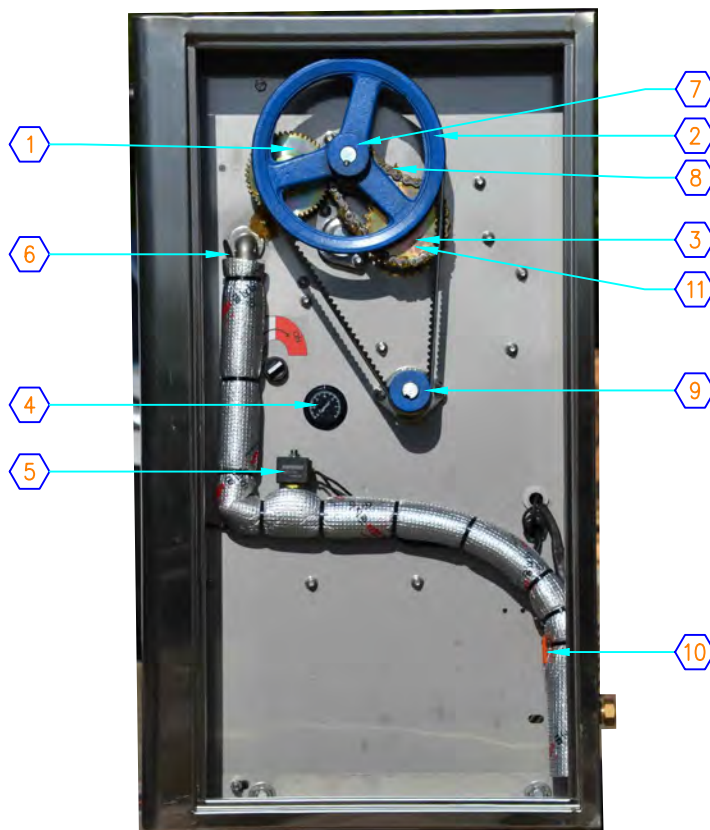

#	NAME
1	SPUR GEAR, 50 TOOTH
2	9" PULLEY
3	CHAIN SPROCKET
4	THERMOSTAT
5	3/8 SOLENOID
6	PIPE HEATING WIRE
7	SPROCKET 12T X SPURGEAR 24T
8	#40 CHAIN
9	2" PULLEY
10	15A BALL V/V
11	CHAIN SPROCKET, 24 TOOTH

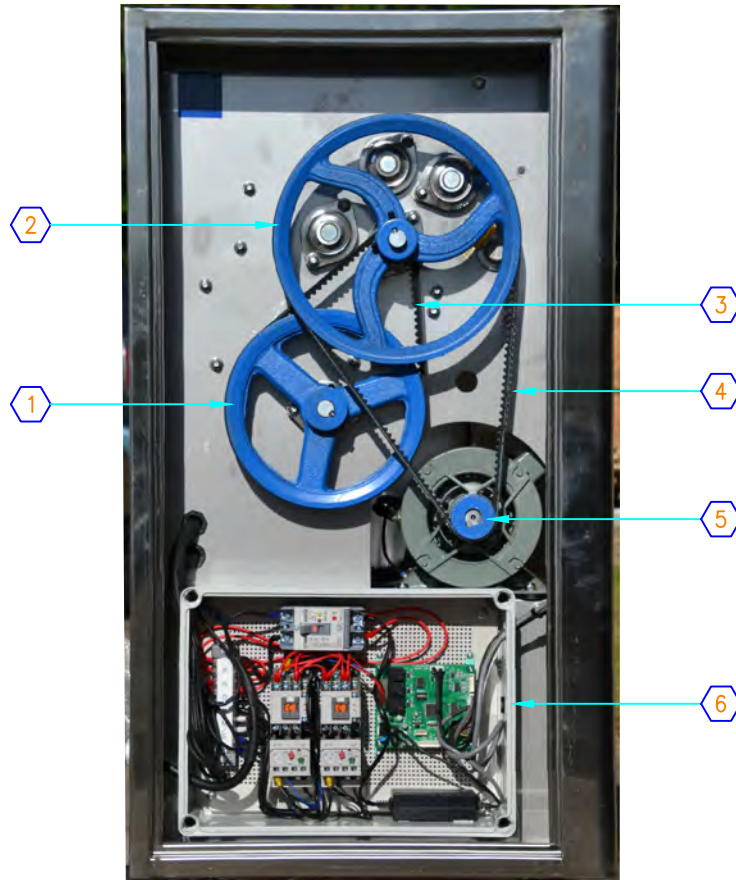

#	NAME
1	9" PULLY
2	11" PULLY
3	V 38 BELT
4	V 43 BELT
5	2" PULLY
6	ELECTRICAL BOX

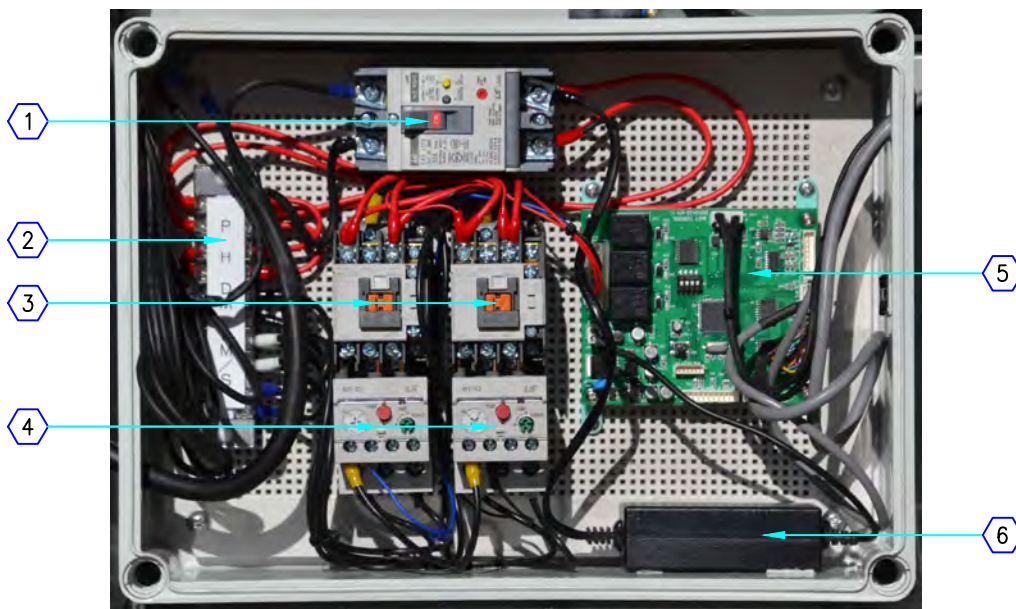

#	NAME
1	CIRCUIT BREAKER
2	TERMINAL BLOCK
3	MAGNETIC CONTACTOR
4	THERMAL OVERLOAD (UL)
5	PCB CONTROLLER
6	TRANSFORMER

Electric Control Box Diagram

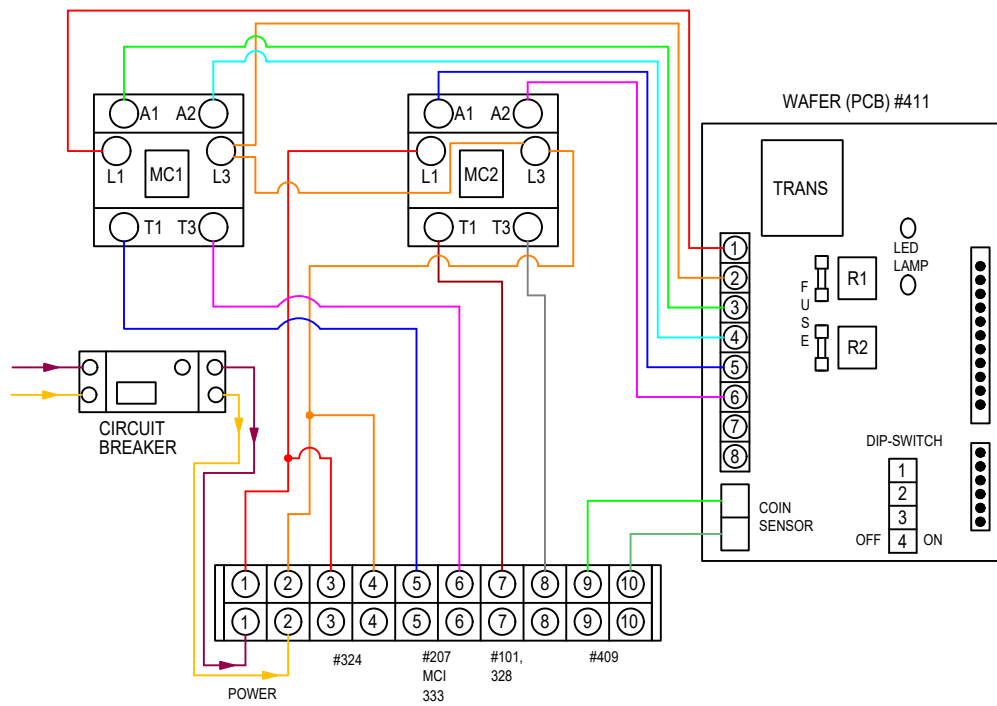

Electric Drawing

